

A UNIQUE PLACE FOR A ROYAL EXPERIENCE

Welcome at the foot of the
royal castles Hohenschwangau
and Neuschwanstein



AMERON

NEUSCHWANSTEIN
ALPSEE RESORT & SPA

Althoff Hotels

DEAR GUESTS,

A HEARTFELT WELCOME TO AMERON NEUSCHWANSTEIN ALPSEE RESORT & SPA!

I am delighted to welcome you at this unique, royal, and magic place.

Our resort excels with its unique location directly on the shore of the crystal clear Alpsee. From here you can enjoy the breathtaking view of the royal castles and the surrounding Alpine panorama. This location, chosen by King Ludwig II to make his dream of a fairy-tale castle come true, has a regal atmosphere and breathes history.

Discover our stylishly decorated rooms, let yourself be indulged by culinary delights in our restaurants and refuel your energy in the 4 elements spa. The untouched nature of the Allgäu offers a variety of leisure activities. Whether you prefer to be active and hike, cycle, or go paragliding, or perhaps have a relaxing day at the lake – you will find many opportunities to enjoy your stay to the full.

Spoil yourself with a stay in this special place and let yourself come under the spell of the magic of AMERON Neuschwanstein Alpsee Resort & Spa. Our team is looking forward to welcoming you here and will provide you with an unforgettable sojourn.

Warmest Greetings,
Yours,

Razvan Tiberius Kefer
General Manager of
AMERON Neuschwanstein
Alpsee Resort & Spa



IN THE NEAR VICINITY OF THE ROYAL CASTLES

A unique mix of culture, nature, and the history of the House of Wittelsbach – AMERON Neuschwanstein Alpsee Resort & Spa.

In one of the most celebrated places in Germany, AMERON Neuschwanstein Alpsee Resort & Spa combines several historic, traditional residences to create a resort with 136 rooms and junior suites, a conference and event area, the 4 elements spa, and a variety of gastronomic opportunities.

At the foot of both royal castles, Hohenschwangau and Neuschwanstein, surrounded by forest and with a view

of the Alpsee, the resort and spa was created in an over 100-year-old ensemble of buildings, whose touristic history goes back to the times of the Royal Court.

The complex of buildings, the traditional residences Schlosshotel Lisl, Jägerhaus (Hunting Lodge), and Alpenrose were carefully renovated and the modern builds Galeria and Seehaus (Lake House) completed the whole.



The traditional residence Alpenrose, situated directly on the shore of the Alpsee at the foot of both royal castles Hohenschwangau and Neuschwanstein.

FACTS AND FIGURES

AMERON
Neuschwanstein
Alpsee Resort & Spa



136 rooms and junior suites, 4 conference rooms, 1 ballroom, 3 event areas, restaurants, Ludwig Bar, 4 elements spa.

- 136 rooms and junior suites
- 4 conference rooms in the main building
- 1 ballroom Richard Wagner
- 3 separate event rooms in the Alpenrose
- Lisl Restaurant and Terrace
- Alpenrose am See Restaurant and Terrace
- Schloss Bräustüberl with the Alpseestube and beer garden
- Ludwig Bar
- 4 elements spa by Althoff
- Free WiFi
- Hotel parking

AT A GLANCE

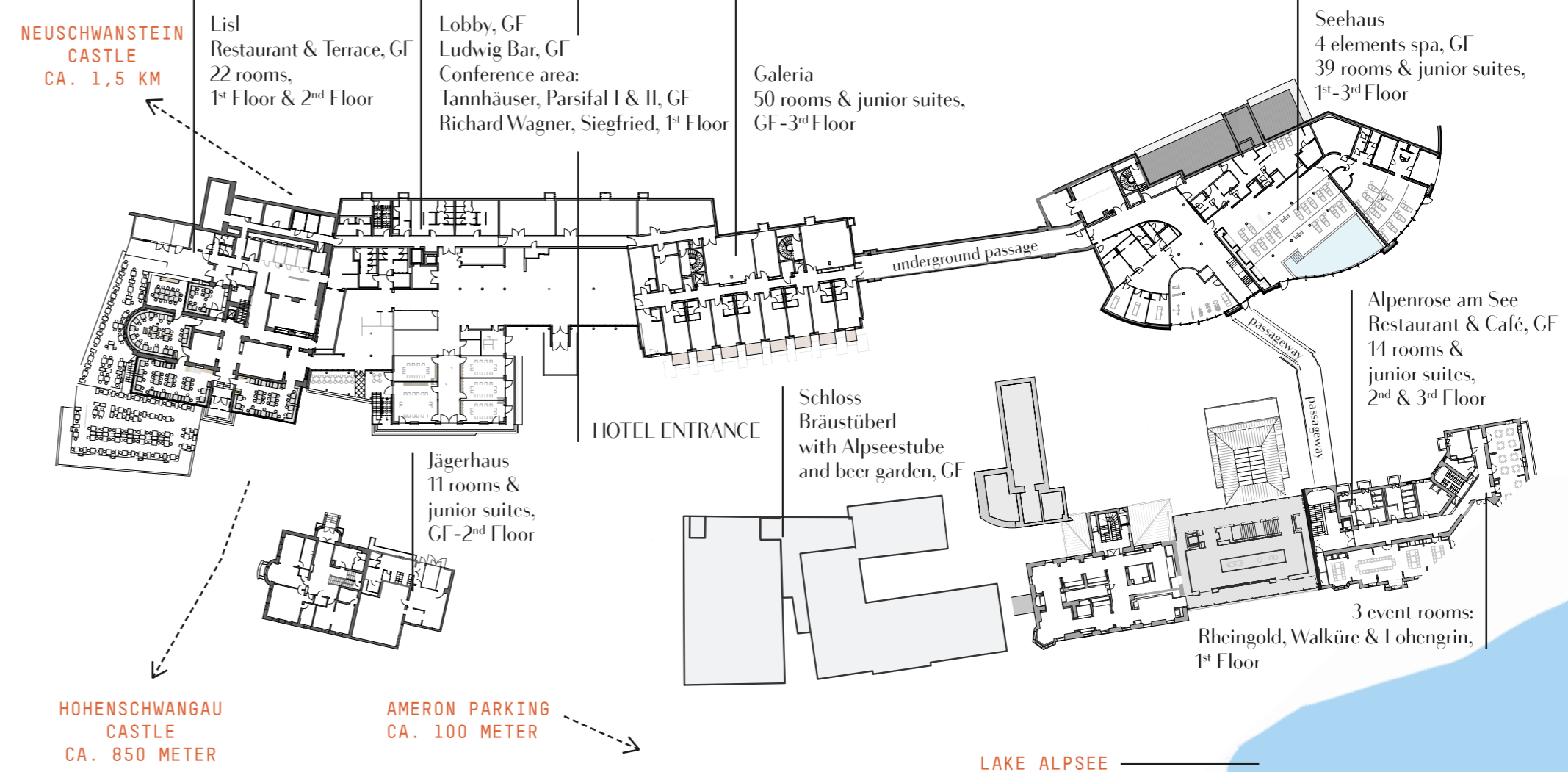

HISTORY AND MODERNITY

Revive and
breathe history



AMERON Neuschwanstein Alpsee Resort & Spa resurrects a traditional ensemble of buildings.



The 3 residences of tradition, Lisl, Jägerhaus (Hunting Lodge), and Alpenrose are the basis of AMERON Neuschwanstein Alpsee Resort & Spa, which has been intertwined with Hohenschwangau for more than 100 years.

The residences have been fully renovated and, together with the modern builds Galeria and Seehaus (Lake House) create a new ensemble: a unity which breathes history and continues the tradition.

Altogether 136 rooms and junior suites, conference rooms, the 4 elements spa with a fine view over Alpsee, as well as various gastronomical offerings, are merged in this spacious resort.

The combination of tradition and modernity continues within the interior of AMERON Neuschwanstein. Warm colours and natural materials such as wood,

leather, and linen recall historic interiors, but with a contemporary interpretation. Minimalistic accessories, muted touches of colour and exclusive designer furniture create an ambience which is second nature to the tradition and zeitgeist of Hohenschwangau.

AMERON Neuschwanstein resurrects a traditional ensemble of buildings. 3 Hohenschwangau residences – Alpenrose, Jägerhaus, and Lisl – whose history goes back to the era of the Royal Court – create a dynamic symbiosis with the 2 contemporary builds Galeria and Seehaus: Tradition meets modern, history meets zeitgeist.



HAVE A GOOD NIGHT'S SLEEP WITH US!



The new look AMERON Neuschwanstein Alpsee Resort & Spa follows the concept of balanced contrasts.



MAIN RESIDENCE AND GALERIA From Lisl you can access the main residence for the lobby and Ludwig Bar, as well as the conference rooms on the ground and 1st floor.

Directly connected to this you will find the newly built Galeria with a total of 50 rooms in the categories, standard, comfort, deluxe, as well as junior suites and family rooms.

Relax and enjoy the view of Hohenschwangau or the forest in all the rooms.

SEEHAUS (Lake House) An underground access leads you directly to the Seehaus – an access made special by an elaborate system of lighting and variously decorated display cases.

The Seehaus was also newly erected, and has 39 rooms of the categories, standard, comfort, deluxe, junior suites and family rooms, as well as on the whole of the ground floor, the 4 elements spa with a view over the Alpsee – including a sunset.

It makes no difference what room you book, an idyllic view of the castle of Hohenschwangau, of the forest or the Alpsee is guaranteed.



LISL Near the entrance to our resort is the former Schlosshotel Lisl. Here we find the Lisl Restaurant and Terrace where, among other things, a breakfast buffet is served for all resort guests. On the 1st and 2nd floor there are in total 22 rooms of the categories standard and comfort.

A highlight is the wonderful view from all the rooms of the castles of Hohenschwangau or Neuschwanstein.

JÄGERHAUS (Hunting Lodge) Situated directly opposite the Lisl, this historic building was carefully renovated retaining the original picturesque style. In total there are 8 rooms and 3 junior suites with sizes of up to 43m² for you.

Enjoy the fairy-tale, romantic interior design with antiques, beds with canopies, and patterned wallpapers, as well as the wonderful views from all the rooms and junior suites of the castles of Hohenschwangau or Neuschwanstein.

ALPENROSE The historic building of Alpenrose am See Restaurant and Café earns its name from its location directly on the shore of the Alpsee. The spacious terrace is especially inviting to linger and savour it all. On the 1st floor there are 3 event areas which can be connected, and are perfect for private events such as birthdays, weddings, and jubilees, or even for small, select meetings, and other events.

A glass covered pathway leads you away from Seehaus to Alpenrose. As an alternative, you can use the main entrance in Alpeestrasse directly near the Museum der Bayerischen Könige (Museum of the Bavarian Kings).

The 2nd and 3rd floors offer our guests 14 new and quality appointed rooms of the category comfort, deluxe, and junior suites for a top level, comfortable and relaxing stay.

CULINARY ART AND TRADITION

Relaxation and pleasure to suit every taste

OUR VERSATILE GASTRONOMIC POSSIBILITIES

The existing historic buildings Alpenrose and Lisl, Schloss Bräustüberl and Alpeestube form the core of the AMERON Neuschwanstein Alpsee Resort & Spa.

This culinary trio caters for the individual requirements and target groups – whether guest or visitor, be it breakfast or lunch, coffee and cake, or dinner and drinks.

Each of the three residences offers a carefully coordinated gastronomic concept. These are complemented by the Ludwig Bar which serves as the central meeting point of AMERON Neuschwanstein.



LISL RESTAURANT AND TERRACE Our restaurant in the historic building, which was the former Schlosshotel Lisl has, at any time of the day, a very special ambience. In the grand winter garden, and on the terrace of the residence, you can enjoy the beautiful views of the area.

Our top chef and his team will indulge you with contemporary Bavarian Alpine cuisine. During the day you can enjoy our abundant choice of cakes at the buffet. We also provide individual menus according to your wishes.

Our culinary credo: The ingredients for our cuisine must be seasonal, regional, and chosen with a particular eye for quality. Thus, the cheese comes from the cheese manufacture Hoch Alp in nearby Buching and is made from meadow-grazed milk. The meat and sausages originate from the country butcher Baur & Kaufmann, which processes only regional livestock. We source our regional fruit and vegetables from the Island of Reichenau in the Bodensee region [Lake Constance], while the bakery goods and sour dough bread are delivered daily, fresh from Gschwill Bakery. Last but certainly not least, a fine selection of wines will round off your culinary experience in Lisl.



LISL RESTAURANT & TERRACE Contemporary Bavarian Alpine cuisine with a superb view of the castles of Neuschwanstein and Hohenschwangau.



SCHLOSS BRÄUSTÜBERL Down to earth, rustic, and cosy: In Schloss Bräustüberl, Alpeestube and its beer garden you can experience up close the romance of the Allgäu.

The food is simply excellent! This is because authentic, local, Bavarian cuisine is served here. The meat, sausage and cheese specialties originate from regional butchers and cheesemakers and are best enjoyed with a freshly tapped beer from the König Ludwig Schloßbrauerei Kaltenberg.

Depending on the season, you may sit in our spacious parlour, or in our sunny beer garden – naturally with a view of the Alpine panorama and the Ludwig castles.

Ideal for hikers and day trippers. In the evenings Schloss Bräustüberl is available to hire for private functions.



ALPENROSE AM SEE

ALPENROSE AM SEE RESTAURANT & CAFÉ
 You will certainly enjoy the most beautiful view of the Alpsee in Alpenrose am See. To be more exact – on our superb terrace, where you can watch the reflections on the lake in a relaxing atmosphere. This is the perfect place to enjoy a cool drink or the delicious ice cream creation “King Ludwig Glace Royale”. Alpenrose has seasonal opening hours.

Not only does Alpenrose am See owe its special atmosphere to the outstanding location, but also the residence itself is a true jewel. It has characterised the appearance of Hohenschwangau for over

100 years. We have restored it with care and modernised it for today’s requirements - without changing its typical regional charm.

Alpenrose, with its traditional architecture and uninterrupted view of the Alpsee, offers a unique setting for weddings, family gatherings, and select gala dinners (10-86 persons).



ALPENROSE AM SEE
 Culinary enjoyment with an impressive view of the Alpsee.



LUDWIG BAR

LUDWIG BAR The atmosphere in the bar is stylish but shaped by the royal history of Neuschwanstein. Ludwig Bar is the central meeting place in AMERON Neuschwanstein Alpsee Resort & Spa. A comfortable, cosy place at the foot of the Bavarian royal castles – ideal for a relaxing close to a day out in the country air, for an informal get-together with business partners, or for a digestif after the culinary experience in one of our restaurants.

True to the maxim “Classic meets Bavaria” we concentrated on a choice of classical drinks and on local creations. You can enjoy our creative signature drinks, a unique mix of flavours, their names inspired by the history of the area, such as “Sissi” or “Richard Wagner” which will take you on a journey into the past.

In our kitchen there are international touches as well as Schwangau specialties – such as seasonal herbs and regional products from Allgäu.

So that you can fully enjoy the exquisite flavours of our dishes in your own private place, we will gladly provide you with meals from the Ludwig Bar as room service.



LUDWIG BAR
 “Classic meets Bavaria”
 A fine choice of drinks and local creations.

EVENTS AND CONFERENCES

Room for your ideas and your success



An unforgettable ambience for weddings, family gatherings, or gala dinners, as well as a flexible space for business events.



SAY I DO!

Do you want to say "I Do" in one of the most romantic places in Germany? It couldn't be more beautiful right here – for example, with a reception on our Alpenrose terrace with a view of the Alpsee, followed by a romantic celebration in one of the separate event rooms on the 1st floor. Or maybe you want a fabulous party in the grand Richard Wagner ballroom with room for up to 180 guests?

We will happily cater for all your wishes to create an unforgettable day for you – give us a ring and make an appointment. Your ideas will never be eccentric enough for us!

AN EXCEPTIONAL LOCATION FOR PRIVATE OR BUSINESS EVENTS

All rooms can be booked for events of all sizes – from board meetings, conferences and workshops to team and social events. We are offering space for 10 to 220 persons.

Some of the rooms can be combined with each other and equipped with variable seating arrangements.

In this way, small, intimate celebrations can be organised in Alpenrose, as well as events with large parties in the main building.

| BUILDING | ROOM | BLOCK | U-SHAPE | BANQUET | PARLIAMENT | THEATRE | M ² | ↑ ↓ M | L x W (M) |
|----------------------------------|-------------------|-------|---------|---------|------------|---------|----------------|-----------|---------------|
| MAIN BUILDING GF | TANNHÄUSER | 16 | 14 | 30 | 18 | 40 | 58 | 3.40 | 8.15 x 7.08 |
| MAIN BUILDING GF | PARSIFAL I | 16 | 14 | 30 | 12 | 24 | 46 | 3.40 | 6.50 x 7.08 |
| MAIN BUILDING GF | PARSIFAL II | 24 | 18 | 40 | 30 | 40 | 59 | 3.40 | 8.40 x 7.08 |
| MAIN BUILDING GF | PARSIFAL I AND II | 30 | 30 | 70 | 50 | 70 | 105 | 3.40 | 14.90 x 7.08 |
| MAIN BUILDING 1 ST FL | SIEGFRIED | 24 | 30 | 70 | 50 | 80 | 133 | 2.70 | 10.31 x 12.86 |
| MAIN BUILDING 1 ST FL | RICHARD WAGNER | 60 | 52 | 180 | 160 | 220 | 344 | 3.60–6.60 | 19.92 x 17.26 |
| ALPENROSE 1 ST FLOOR | RHEINGOLD | 28 | - | - | - | 40 | 69 | 3.20 | 2.90 x 5.30 |
| ALPENROSE 1 ST FLOOR | WALKÜRE | 20 | - | - | - | 24 | 42 | 3.20 | 9.00 x 4.80 |
| ALPENROSE 1 ST FLOOR | LOHENGRIN | 54 | - | - | - | 60 | 106 | 3.20 | 3.20 x 4.50 |
| SCHLOSS BRÄUSTÜBERL | | - | - | 140 | - | - | - | | |
| ALPSEESTUBE | | - | - | 56 | - | - | - | | |

MEET AND CELEBRATE

The right rooms for your success

The new lobby and conference building create the right setting for a variety of events in a business context. 5 stylishly appointed, light flooded and partly combinable rooms of 46 m² to 344 m², as well as the latest technical developments for conferences – this is an ideal location for challenging business events, and for team building or incentives.

TANNHÄUSER
58 m² | Space for up to 40 persons.

PARSIFAL I
46 m² | Space for up to 24 persons.

PARSIFAL II
59 m² | Space for up to 40 persons.

PARSIFAL I AND II
105 m² | Space for up to 70 persons.

SIEGFRIED
133 m² | Space for up to 80 persons.

RICHARD WAGNER
344 m² | Space for up to 220 persons.



Tradition and a unique ambience - Alpenrose.



The traditional residence Alpenrose creates an unforgettable ambience for weddings, family celebrations, or gala dinners. In each of the 3 event spaces, Rheingold, Walküre and Lohengrin and the spacious terrace, you can enjoy an uninterrupted view of the Alpsee.

The rooms can be combined with each other and are equipped with variable seating arrangements (10 to 18 persons).

All rooms offer a view of the Alpsee, and in some of them also a view of Schloss Hohenschwangau and have a private access to the balcony.

This way, small, intimate celebrations can be arranged in the Alpenrose, as well as larger events with space for dancing and music.

RHEINGOLD
69 m² | Space for up to 40 persons.

WALKÜRE
42 m² | Space for up to 24 persons.

LOHENGRIN
106 m² | Space for up to 60 persons.



BEAUTY AND WELL-BEING

In our
4 elements spa

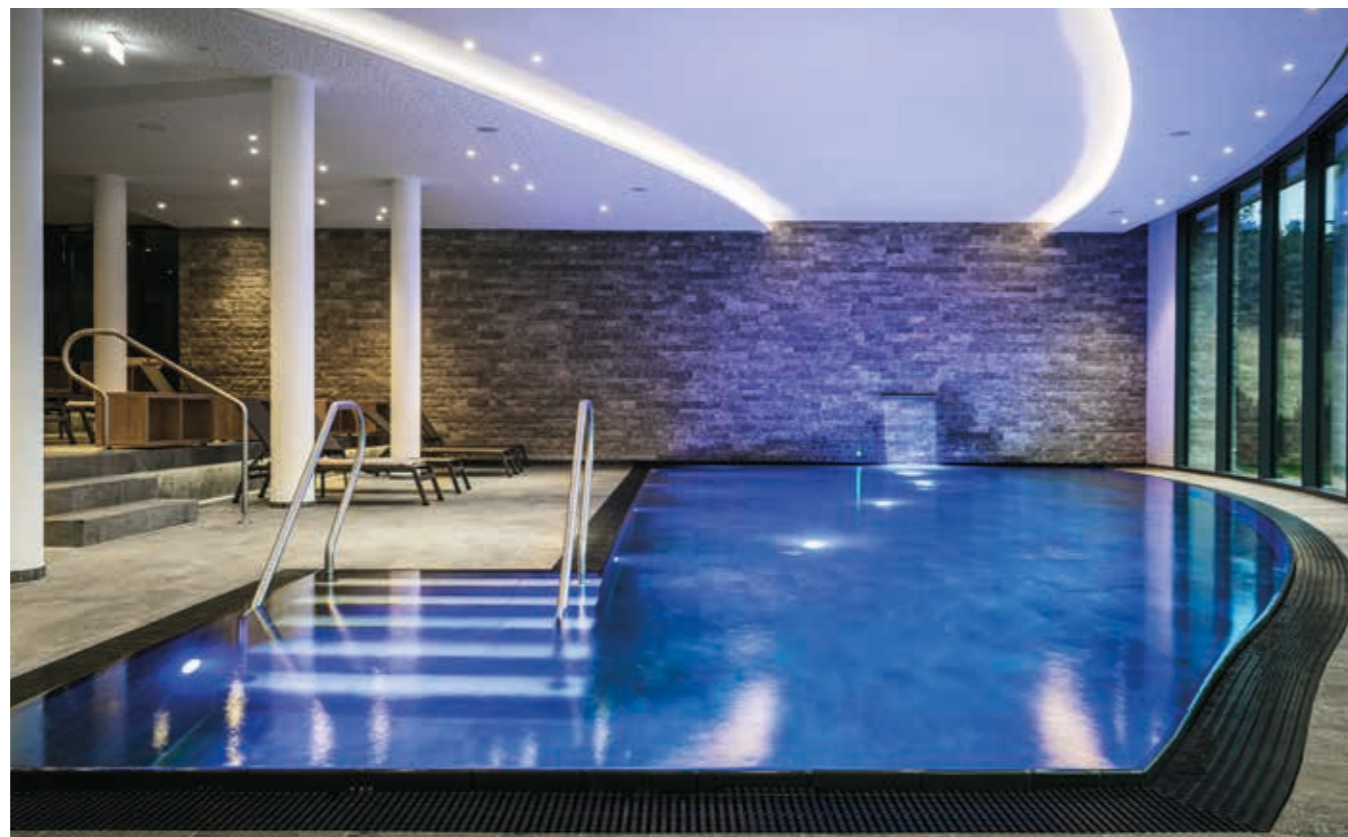

4 elements spa

by Althoff

In the 4 elements spa, 850 m² of authentic Allgäu Alpine wellness await you. Fire and water, air and earth: Since antiquity, the renowned teachings of the four elements hold that all living beings originate from this elementary power, and that harmony and well-being depend on their perfect balance.

Inspired by traditional knowledge of the healing effect of nature, a holistic approach is core to our 4 elements spa. The composition of space, time, and nature promises well-being, health, and harmonising energy.

In the treatment area, you can have body or facial treatments which are wholly inspired by natural care and anti-aging.

Discover the ARAMO ELIXIR, a true gift of nature. A new dimension of holistic skincare and rejuvenation. A small, anti-aging wonder product without equal. The ARAMO ELIXIR is exclusively available in the 4 elements spa.

POOL with a waterfall and view of the Alpsee

BIO-SAUNA 60 °C with high humidity and ethereal oils

LADIES SAUNA and FINNISH SAUNA 90 °C

EXPERIENCE SHOWERS with an invigorating and soothing effect

ICE FOUNTAIN pleasant for cooling off after a sauna

QUIET ROOM a place of quietude and relaxation with comfortable sun beds

QUIET AREA Kneipp-warmth-foot baths, sun beds and an outside terrace

SPA LOUNGE

KIDS-SPA In our splash-time (daily from 1 pm to 3 pm) kids accompanied by their parents can splash about and play to their hearts' content.



You can find detailed information on our spa and the treatments in our 4 elements spa brochure.

DISCOVER HOHEN- SCHWANGAU AND THE REGION



© erlebe.bayern – Gert Kroutbauer



© Allgäu GmbH
Simone Zehnpfennig

IMPRESSIVE MOUNTAINS, FAIRYTALE CASTLES, AND IDYLIC LAKES

The Schwangau community near Füssen in Allgäu is, for obvious reasons, one of the most visited holiday destinations in Germany. The natural beauty of the area once attracted King Ludwig II, who found a paradisaal refuge here. By building the castle of Neuschwanstein, he realised his dream – and created a monument in the present district of Hohenschwangau that fascinates us until today. Together with the castle of Hohenschwangau opposite, the former summer residence of Maximilian II, Neuschwanstein comprises one of the most famous German attractions. Well over one million visitors

come to Schwangau. This is not only due to the beauty of the castles. The exceptional landscape and location, situated between the crystal clear waters of the Schwansee and Alpsee, and the mountainous skyline of Säuling and Tegelberg, Schwangau, offers the visitor an incomparable panorama. The rich meadows, moors and forest landscape make this area of Ostallgäu a particularly varied holiday destination for nature lovers. Beginners, as well as experienced hikers can choose from several diverse routes in the valley, or in the mountains. There are water sport opportunities such as sailing or surfing on the nearby Foggensee. Bicycle tours

are the best way for sightseeing – favourite destinations are Wallfahrtskirche St. Coloman, or the excavations of the Roman bath house (Roman Villa) on Tegelberg-Talstation.



Experienced mountain bikers and racing cyclists can go on lengthy tours to one of the charming Alpine huts, or in neighbouring Tyrol. In winter, the ski slopes and tracks in Schwangau provide the best conditions for slope and cross-country skiing, snowboarding, and sledding. It is never boring for children in Schwangau due to the adventure playground at the foot of Tegelberg. Excursions to the Forest Adventure Centre, riding, or visits to a farmyard and many other vacation possibilities.

For those interested in culture there are also a variety of things to discover. The community of Hohenschwangau is on the Romantic Road. You can discover the historic old town of Füssen, visit the famous Wieskirche – declared by UNESCO to be a World Heritage Site, or go to the ruins of Falkenstein Castle and back to the times of chivalry.



© erlebe.bayern – Tobias Gerber

Thanks to this unique mix of culture and nature, every visitor to Schwangau can find a perfect balance between leisure, sports, and well-being.

HOW TO FIND US



- Füssen Railway Station 4 km
- Memmingen Airport 85 km
- Augsburg Airport 115 km
- Munich Airport 155 km
- Stuttgart Airport 220 km



GIFT A WONDERFUL EXPERIENCE!

WHETHER SUPERB CUISINE, OVERNIGHT STAYS IN DREAMY LOCATIONS, RELAXING IN OUR SPAS, OR GIFT VOUCHERS, YOU CAN FIND A GIFT HERE TO PLEASE EVERYONE:

Choose your mode of shipping: print@home-gutschein | standard per post | exclusive gift voucher

ALL GIFT VOUCHERS ARE AVAILABLE ONLINE IN OUR VOUCHER SHOPS:
gutscheinshop.althoffcollection.com
gutscheinshop.ameroncollection.com



ALTHOFF HOTELS

Wonderful places of hospitality and enjoyment

ALTHOFF COLLECTION

Althoff Grandhotel Schloss Bensberg, Bergisch Gladbach/Cologne
 Althoff Hotel Fürstenhof, Celle
 Althoff Seehotel Überfahrt, Rottach-Egern
 Althoff Hotel Villa Belrose, Saint-Tropez
 Althoff St. James's Hotel & Club, London

Althoff Dom Hotel, Köln (coming soon)
 Althoff COLLECTION Hotel Frankfurt (coming soon)

AMERON COLLECTION

AMERON Berlin ABION Spreebogen Waterside
 AMERON Berlin Villa ABION
 AMERON Bonn Hotel Königshof
 AMERON Davos Swiss Mountain Resort
 AMERON Hamburg Hotel Speicherstadt
 AMERON Cologne Hotel Regent
 AMERON Luzern Hotel Flora
 AMERON Neuschwanstein Alpsee Resort & Spa
 AMERON Munich Motorworld
 AMERON Zurich Bellerive au Lac

URBAN LOFT

URBAN LOFT Cologne
 URBAN LOFT Berlin

althoffhotels.com

AMERON NEUSCHWANSTEIN ALPSEE RESORT & SPA
ALPSEESTRASSE 21, 87645 HOHENSCHWANGAU
T +49 8362 7030 0
INFO@AMERON-NEUSCHWANSTEIN.DE

  @AMERONNEUSCHWANSTEIN

AMERONCOLLECTION.COM